

SiltāVIETA GREEN

AIR SOURCE R290 (PROPANE) HEAT PUMP



APPLICATION

SiltāVIETA GREEN is an innovative heat pump that not only heats water for the heating or hot water supply system, but also cools it in the summer for the air conditioning system. Such units are usually designed for residential and commercial buildings.

Due to its environmental friendliness and minimized energy consumption, this type of equipment has become popular.

SiltāVIETA GREEN is available in two versions: **Basic** and **Combo**. The **basic** version of indoor unit is mounted on the wall and doesn't contain a tank. The **combo** version of indoor unit is a floor-standing unit containing one tank for storing domestic water and one for heating water. The outdoor unit is the same for both versions of indoor units. The complete system is controlled from a controller installed on the indoor unit.

BENEFITS:

- **Natural refrigerant.** R290 (propane) is nontoxic, non-corrosive and energy efficient, refrigerant of the future. It has a very low global warming potential and will not be banned by the governments during the fight against the climate change.
- **Quiet work.** It is quiet inside the house because the indoor and outdoor units are designed in the sound proof way. Stepless power control according to current needs also ensures silent operation.
- **Easy to control and install.** The outdoor and indoor units can be immediately connected to a hot water pipeline for domestic needs. The controller for **SiltāVIETA GREEN** allows you to add units to one system if capacity needs to be increased.
- **Smart power adjustment.** Stepless power adjustment and the controller, ensures a high level of product efficiency wisely throughout the year. The controller is connected to the Internet, so it is possible to adjust the heating and cooling intensity according to the current conditions.
- **Built-in cooling function.** **SiltāVIETA GREEN** heat pump is capable of not only heating, but also cooling water. This solution provides maximum comfort in both winter and summer.

SiltāVIETA GREEN Basic	Unit	8	13	15
Min. - max. heat output for A2W35 (EN 14511)	kW	2.1 - 8.3	4.1 - 11.8	6.0 - 14.5
Min. - max. heat output for A-7W35 (EN 14511)	kW	2.0 - 8.3	4.0 - 10.3	6.0 - 13.3
Min. - max. cooling capacity for A35W18 (EN 14511)	kW	3.1 - 10.2	5.1 - 14.0	6.1 - 16.6
Seasonal coefficient of performance «moderate climate» at 35 °C/55 °C (EN 14825)	SCOP	5.3 / 3.9	5.2 / 4.0	5.6 / 4.1
Room heating energy efficiency «moderate climate» 35 °C	η _S	207	203	221
Room heating energy efficiency «moderate climate» 55 °C	η _S	154	154	162
Energy efficiency class heating 35 °C		A+++	A+++	A+++
Supply water temperature	°C	20 - 70*	20 - 70*	20 - 70*
Refrigerant		R290	R290	R290
Dimensions of outdoor unit (width x depth x height)	mm	1575 × 791 × 954	1575 × 791 × 954	1575 × 791 × 1432
Dimensions of indoor unit (width x depth x height)	mm	550 × 280 × 1005	550 × 280 × 1005	550 × 280 × 1005
Outdoor unit sound power level (EN 12102)	dB(A)	46	51	50

* - with return water temperature < 60°C

SiltāVIETA GREEN Combo	Unit	8	13	15
Min. - max. heat output for A2W35 (EN 14511)	kW	2.1 - 8.3	4.1 - 11.8	6.0 - 14.5
Min. - max. heat output for A-7W35 (EN 14511)	kW	2.0 - 8.3	4.0 - 10.3	6.0 - 13.3
Min. - max. cooling capacity for A35W18 (EN 14511)	kW	3.1 - 10.2	5.1 - 14.0	6.1 - 16.6
Seasonal coefficient of performance «moderate climate» at 35 °C/55 °C (EN 14825)	SCOP	5.3 / 3.9	5.2 / 4.0	5.6 / 4.1
Room heating energy efficiency «moderate climate» 35 °C	η _S	207	203	221
Room heating energy efficiency «moderate climate» 55 °C	η _S	154	154	162
Energy efficiency class heating 35 °C		A+++	A+++	A+++
Supply water temperature	°C	20 - 70*	20 - 70*	20 - 70*
Refrigerant		R290	R290	R290
Dimensions of outdoor unit (width x depth x height)	mm	1575 × 791 × 954	1575 × 791 × 954	1575 × 791 × 1432
Dimensions of indoor unit (width x depth x height)	mm	790 × 790 × 1930	790 × 790 × 1930	550 × 280 × 1005
Outdoor unit sound power level (EN 12102)	dB(A)	46	51	50
Storage tank capacity (hot water storage tank)	litre	295	295	295
Output capacity at 40°C and storage tank temperature at 60°C	litre	570	570	570
Output capacity at 46°C and storage tank temperature at 60°C	litre	469	469	469
Storage tank capacity (heating water storage tank)	litre	93	93	93

* - with return water temperature < 60°C

CONNECTION

Conveniently and easily connect the units using accessories.

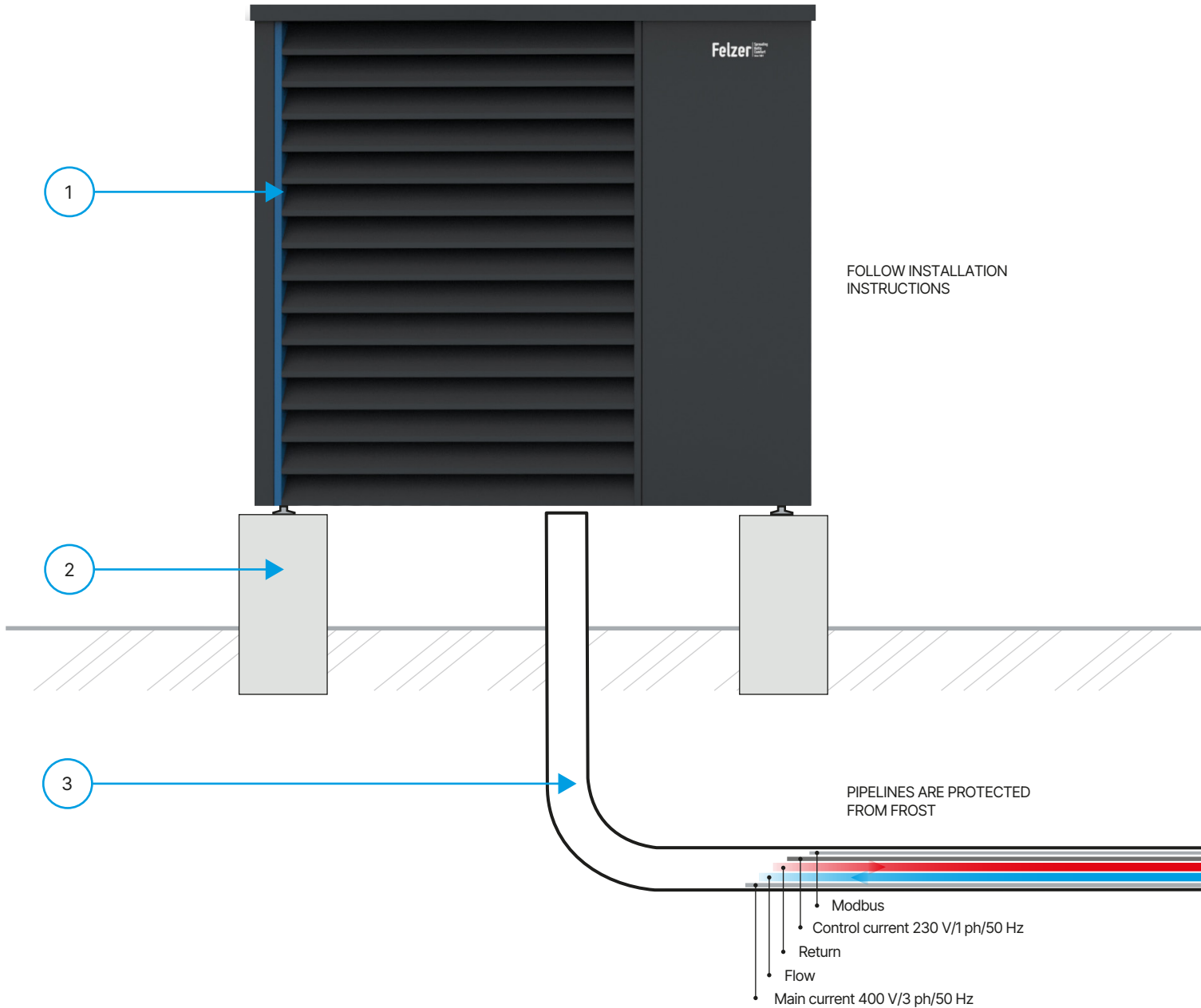

ACCESSORIES:

1. **Connection set** to easy and quick assembly liquid line
2. **Concrete base** for outdoor unit to prevent vibration
3. **HP pipe** for protecting of pipeline
4. **Connector set HP line** for insulated high pressure line
5. **Impressed current anode** to protect to a storage tank from corrosion
6. **Separation system** for separating the heating circuit from the primary heating circuit
7. **Set of vibration decoupler** reduces noise and vibration of the indoor unit
8. **Kit for connection** for direct heating/cooling circuit without mixer for mounting in indoor unit.

CONNECTION

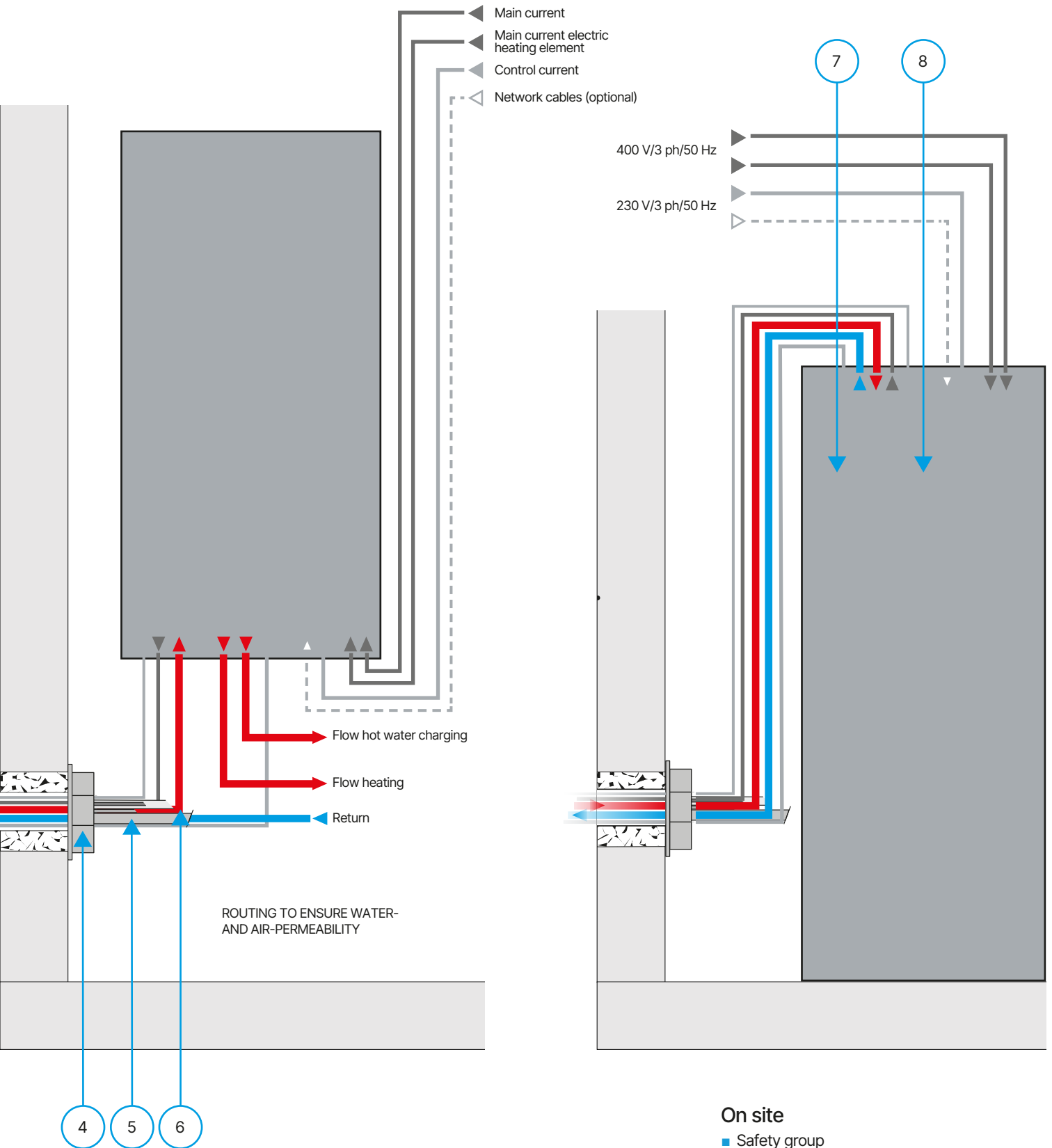

On site

- Safety group
- Diaphragm pressure expansion tank
When the pressure of the closed-circuit increases, the diaphragm pressure expansion tank absorbs the liquid or vapor and thus protects the system from damage.

CONNECTION

SiltäVIETA GREEN Basic allows you not only to heat the liquid for space heating but also to heat the potable water above the temperature required for sanitary use. Cold potable water is accumulated in a separate tank and is heated for domestic hot water (DHW) supply via the heat exchanger integrated in the tank (tank is supplied separately). All the system is controlled by **SiltäVIETA GREEN Controller**.

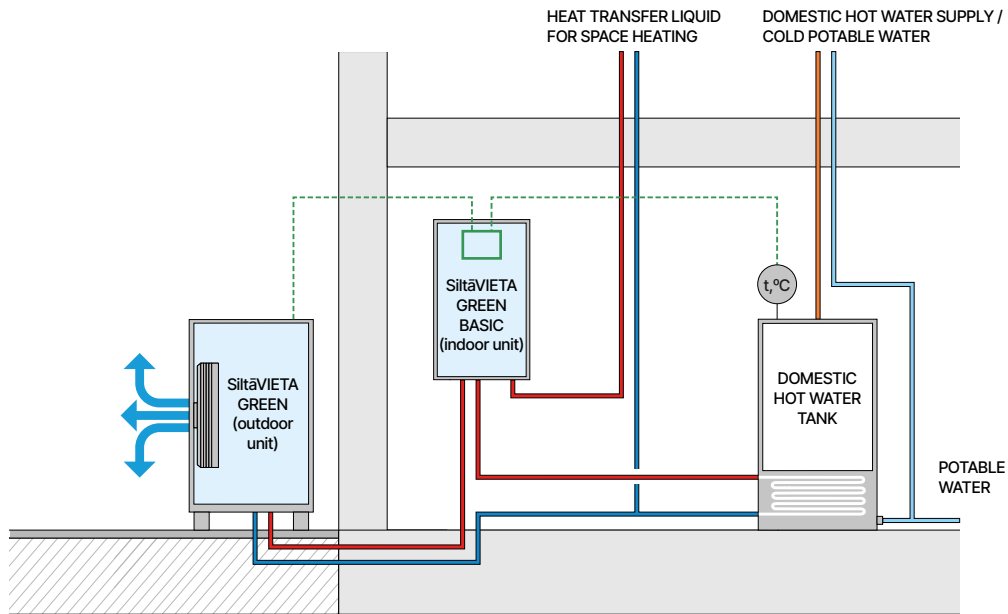

If you need you can add cooling to the same system based on **SiltäVIETA GREEN Basic**. In the warm season, cooled liquid can be supplied to the fan coil or chilled beams and create comfortable conditions in the room. We advice to add a tank in the system. Domestic hot water supply will be also prepared together with cooling and all the system will be controlled by **SiltäVIETA GREEN Controller**.

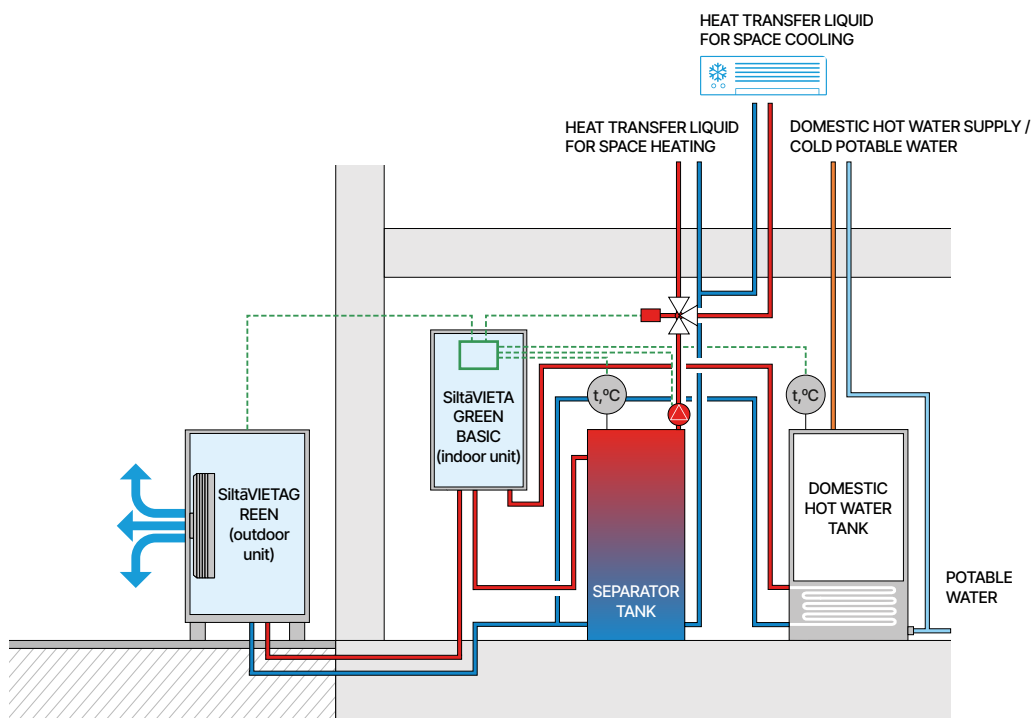

CONNECTION

SiltäVIETA GREEN Combo allows you to have all the same features as Basic but also reduce piping and installation footprint. Combo version integrates 2 tanks – one for space heating, second for DHW. And you do not need to make additional plumbing installation in the room. So if you do not have a lot of free space in the room we recommend Combo version.

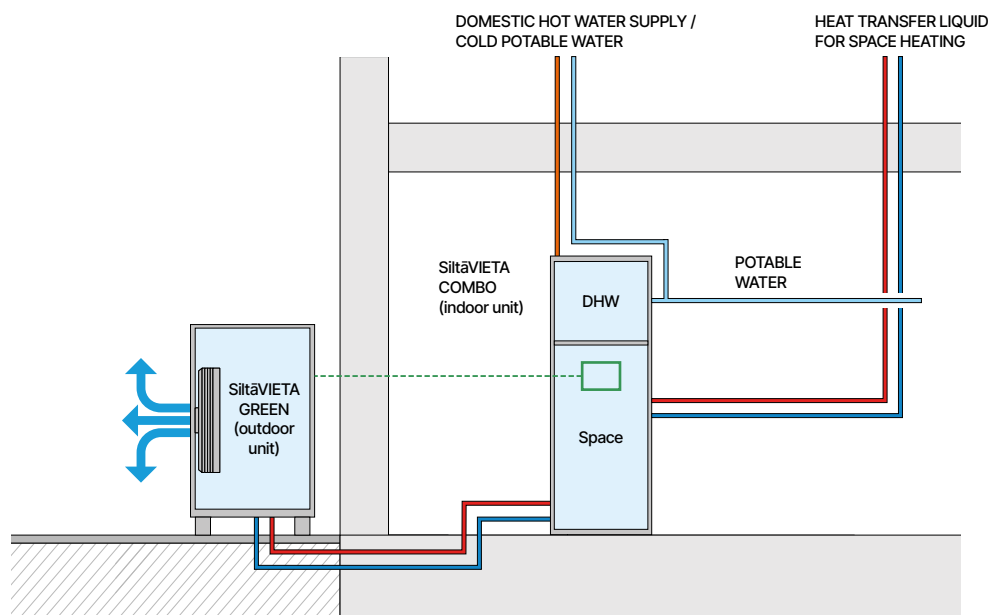

SiltäVIETA GREEN Combo also allows to integrate cooling system while reduce piping and installation footprint. So, use Combo version for heating and cooling if you install the indoor unit in the tight spaces..

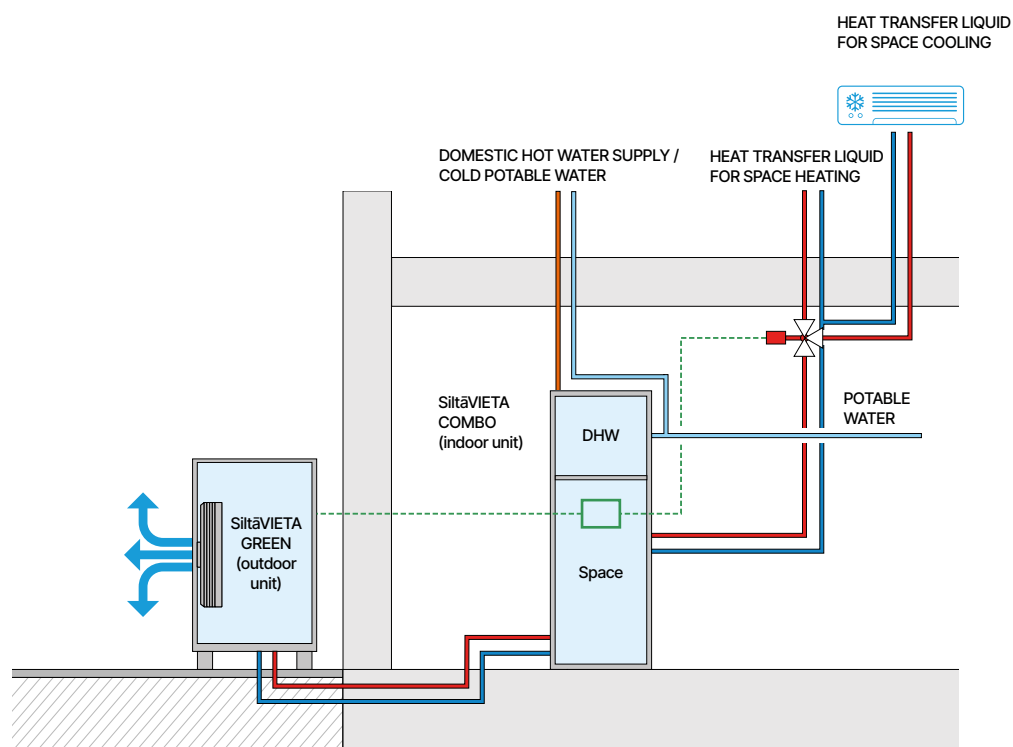

Felzer SIA
Latvia, Riga, LV 1039, Brivibas gatve, 201
sales@felzer.lv
www.felzer.lv

Felzer is continuously improving its products. We therefore reserve the right to change the design and specifications without prior notification.

Rights reserved. Felzer and the Felzer logo are registered trademarks of Felzer SIA. All trademarks to which reference is made herein are the property of their owners.

© Felzer SIA 2024